

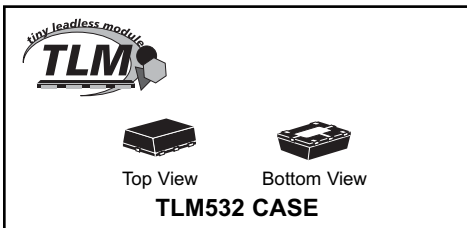

CTLS5064-M532  
CTLS5064R-M532

**SURFACE MOUNT  
SILICON CONTROLLED RECTIFIER**



# Central™ Semiconductor Corp.

## DESCRIPTION:

The CENTRAL SEMICONDUCTOR CTLS5064-M532 and CTLS5064R-M532 (reverse pinout) are epoxy molded PNP Silicon Controlled Rectifiers manufactured in a TLM532 case, designed for control systems and sensing circuit applications.

**CTLS5064-M532 MARKING CODE: CS64**

**CTLS5064R-M532 MARKING CODE: CFF**

## FEATURES:

- Device is **Halogen Free** by Design
- Device is **RoHS** compliant
- High Voltage ( $V_{DRM}=400V$  MAX)

## MAXIMUM RATINGS: ( $T_A=25^\circ C$ )

Peak Repetitive Off-State Voltage	$V_{DRM}$	400	V
Peak Repetitive Reverse Voltage	$V_{RRM}$	400	V
RMS On-State Current	$I_T(RMS)$	0.8	A
Average On-State Current	$I_T(AV)$	0.51	A
Power Dissipation	$P_D$	1.0	W
Operating and Storage Junction Temperature	$T_J, T_{stg}$	-65 to +150	$^\circ C$
Thermal Resistance	$\Theta_{JA}$	77	$^\circ C/W$

## SYMBOL

## UNITS

## ELECTRICAL CHARACTERISTICS: ( $T_A=25^\circ C$ unless otherwise noted)

SYMBOL	TEST CONDITIONS	MIN	TYP	MAX	UNITS
$I_{DRM}$	$V_D=Rated V_{DRM}, R_{GK}=1K\Omega$			1.0	$\mu A$
$I_{RRM}$	$V_D=Rated V_{DRM}, R_{GK}=1K\Omega$			1.0	$\mu A$
$I_{DRM}$	$V_D=Rated V_{DRM}, R_{GK}=1K\Omega, T_A=125^\circ C$			50	$\mu A$
$I_{RRM}$	$V_D=Rated V_{DRM}, R_{GK}=1K\Omega, T_A=125^\circ C$			50	$\mu A$
$V_T$	$I_T=1.2A$			1.7	V
$I_{GT}$	$V_D=7.0V, R_L=100\Omega, R_{GK}=1K\Omega$			200	$\mu A$
$V_{GT}$	$V_D=7.0V, R_L=100\Omega, R_{GK}=1K\Omega$			0.8	V
$V_{GD}$	$V_D= Rated V_{DRM}, R_L=100\Omega, T_A=125^\circ C$	0.1			V
$I_H$	$V_D=7.0, R_{GK}=1K\Omega$			5.0	mA
$t_{ON}$	$V_D= Rated V_{DRM}, I_{GT}=1.0mA, R_{GK}=1.0\Omega,$ $di/dt=6.0A/\mu s$		2.8		$\mu s$

R1 (7-February 2008)

**SURFACE MOUNT  
SILICON CONTROLLED RECTIFIER**

**TLM532 - MECHANICAL OUTLINE**

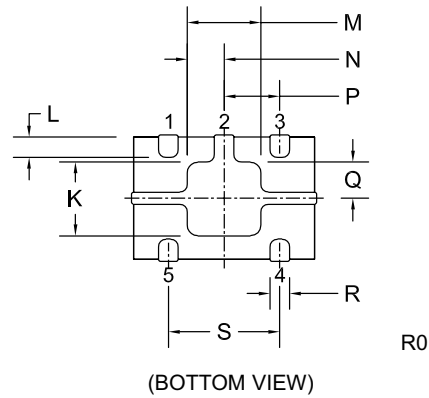
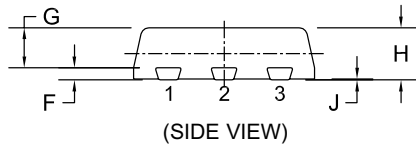
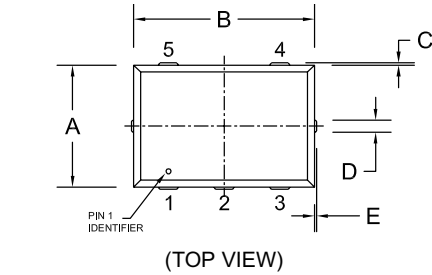

SYMBOL	DIMENSIONS			
	INCHES		MILLIMETERS	
	MIN	MAX	MIN	MAX
A	0.075	0.083	1.900	2.100
B	0.114	0.122	2.900	3.100
C	---	0.005	---	0.125
D	0.007	0.012	0.170	0.300
E	---	0.005	---	0.125
F	0.006	0.010	0.150	0.250
G	0.026	0.030	0.650	0.750
H	0.031	0.039	0.800	1.000
J	0.000	0.002	0.000	0.050
K	0.044	0.052	1.120	1.320
L	0.008	0.018	0.200	0.450
M	0.044	0.052	1.120	1.320
N	0.020	0.028	0.510	0.710
P	0.037		0.950	
Q	0.020	0.028	0.510	0.710
R	0.013	0.017	0.330	0.430
S	0.075		1.900	

TLM532 (REV:R0)

**PIN CONFIGURATION**

**CTLS5064-M532**

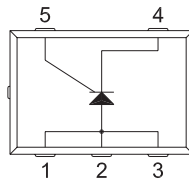

**LEAD CODE:**

- 1) Anode
- 2) Anode
- 3) Anode
- 4) Cathode
- 5) Gate

**MARKING CODE: CS64**

**CTLS5064R-M532**

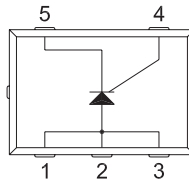

**LEAD CODE:**

- 1) Anode
- 2) Anode
- 3) Anode
- 4) Gate
- 5) Cathode

**MARKING CODE: CFF**

**SUGGESTED MOUNTING PADS**  
(Dimensions in mm)

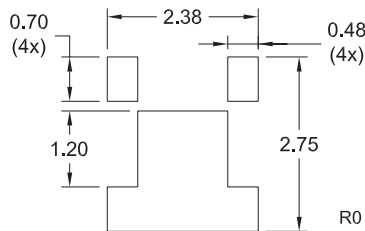

R1 (7-February 2008)